

EAST RIDGE VILLAGE



CLASSIC CHARM :: TIMELESS DESIGN

1827 sq ft
3 bedroom
2.5 bath

THE TRILLIAM

East Ridge Village offers a variety of classic home designs carefully selected for our community. Nestled amidst the natural beauty of Moon Mountain and featuring tree-lined streets; classic architectural elements and quality design details, East Ridge Village will be a truly timeless community.

SELECT THE HOME DESIGN AND LOCATION OF YOUR CHOICE

VISIT US ON-LINE :: eastridgevillage.net

Mike Miller :: Principal Broker office 541-334-7653 cell 541-954-4454



second floor

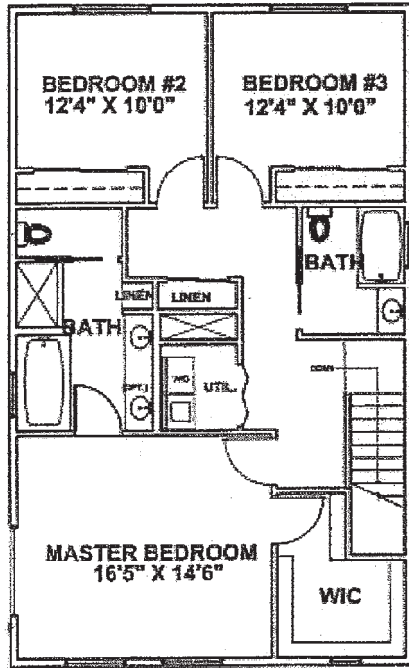

first floor

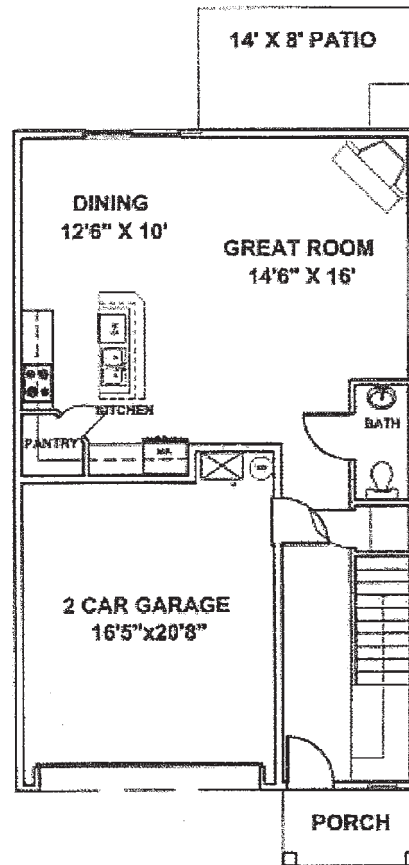

CLASSIC CHARM :: TIMELESS DESIGN

1827 sq ft
3 bedroom
2.5 bath

THE TRILLIAM